



### News

#### Get into the AIA-Wisconsin 2007 Convention for Free

Next month's American Institute of Architects convention for Wisconsin is coming up quickly. This year's convention takes place on May 16-17 at the Monona Terrace convention center. If you are interested in attending, there is a free expo pass that you can download on [AIA's web site](#). If you do attend, be sure to drop by booth #5 and say hello.

#### New Services

We've recently expanded our services to include setup, configuration, and support for the **IPlot** package and **PDF Composer**.

#### Legal Stuff:

We do not sell Bentley products. MicroStation and InRoads are Bentley products and trademarked as such. We only offer this information as a benefit to our subscribers.

### Events

[<< back to top](#)

#### Bentley:

- [BE Conference Europe 2007](#) - Jun 10-14, 2007  
Hilton London Metropole - London, United Kingdom
- [Mid-Continent MicroStation Community 2007 Summer Conference](#) - Aug 23-24, 2007  
Overland Park Convention Center - Overland Park, Kansas
- [The IDDEA Group 2006 Fall Conference](#) - Oct 3-5, 2007  
Scheman Center on Iowa State Campus - Ames, Iowa
- [BCUKI Winter Conference 2008](#) - Feb 28-29, 2008  
Sheraton Heathrow Hotel - London, UK

#### Other:

- [National BIM Conference 2007](#) - May 15-17, 2007  
Anaheim, CA
- [AIA Convention & Products Expo](#) - May 16-17, 2007  
Monona Terrace Convention Center - Madison, WI  
Come visit us in booth #5!

Are there TMC Meetings, Seminars, Trade shows, and Conferences you think are interesting? [Let us know](#) and we will add them to our newsletter.

### IN THIS ISSUE

1. [News](#)
2. [Events](#)
3. [MicroStation tip](#)
4. [InRoads tip](#)
5. [Open enrollment classes](#)
6. [On-site training](#)

### SPREAD THE WORD

Spread the word. Pass this newsletter on to a friend. If a friend forwarded this issue to you, sign up for your own copy.

### QUICK LINKS

- [Click for past issues.](#)



### MicroStation Tip

[<< back to top](#)

## XYZ Text

Delivered with MicroStation is a toolbar that will label coordinates in the file and import/export coordinates. From the MicroStation pulldown menu select **Tools > Annotation > XYZ Text**.



**Label Point** – will label points selected in the drawing. The active text settings are used.

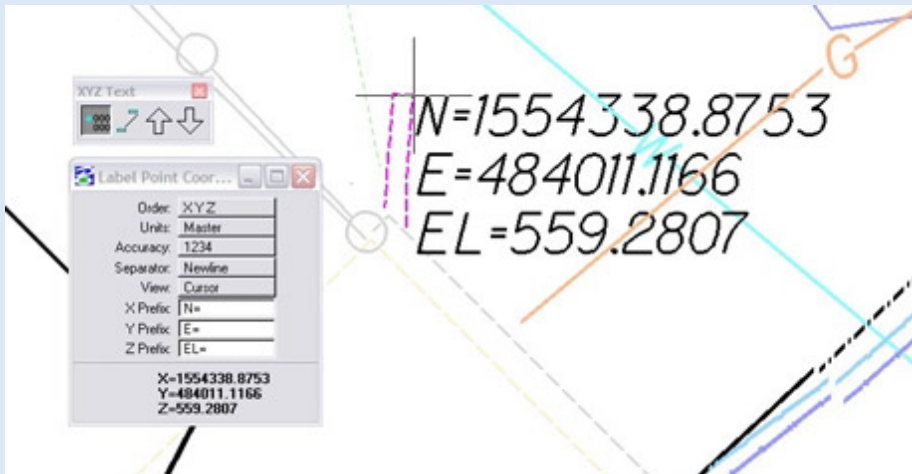

**Label Element** – will label elements in the drawing. Settings include labeling elements individually, by a selection or fence, or all elements in the drawing. The active text settings are used.

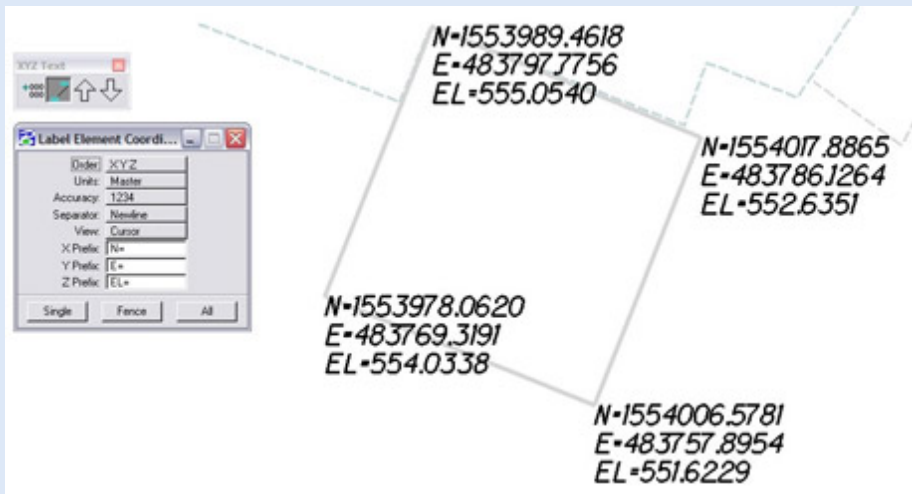

**Export Coordinates** – will export the vertices of elements to a text file. Settings include exporting elements individually, by a selection or fence, or all elements in the drawing. The active text settings are used to label the point number.

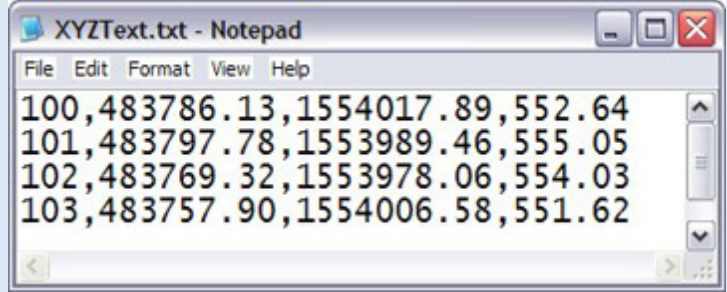
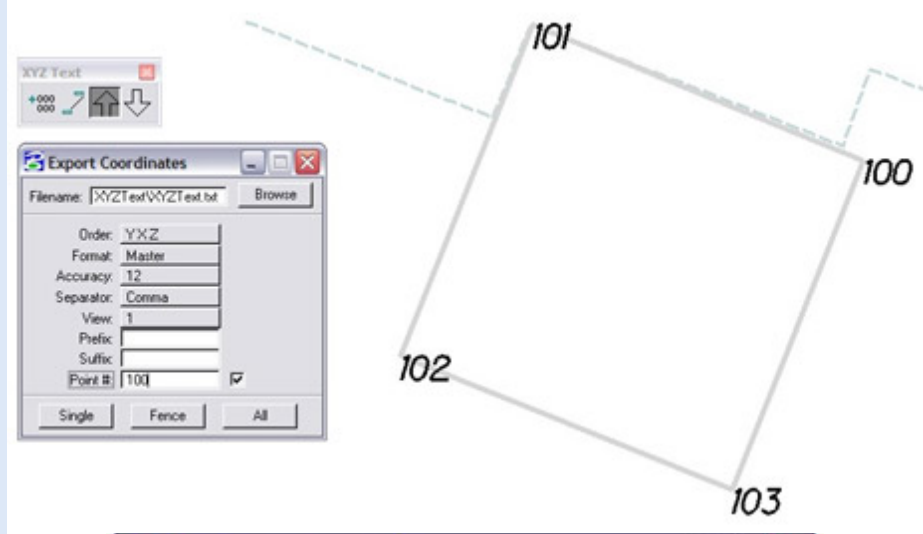

**Import Coordinates** – will import an ASCII text file into the design file. Settings include placing a active point, text character, or cell at each location.

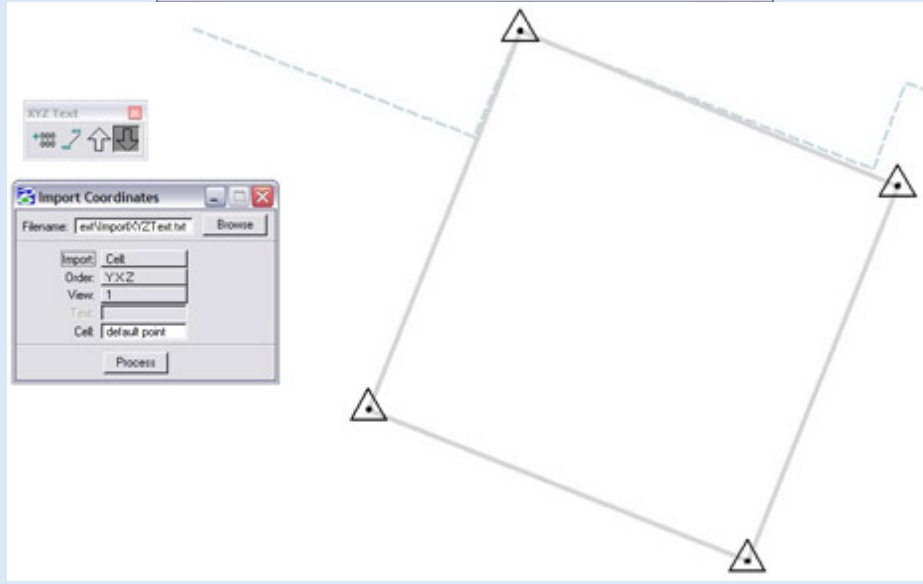
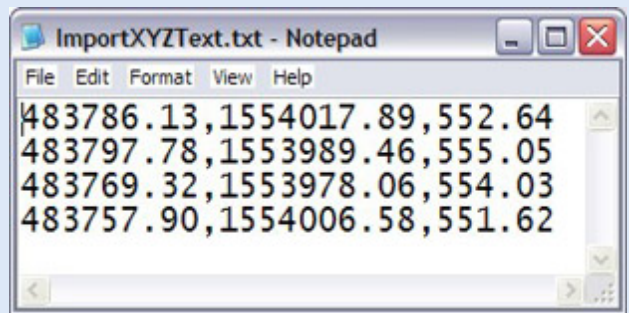

## InRoads Survey Adjustments

In the InRoads Survey product, Fieldbook functions provide tools for adjusting traverses (networks) using least squares and other adjustment routines.

1. Once you get your fieldbook loaded, turn on network display by selecting:  
**Survey > View Survey Data > Network**
2. In the Stations (top half of the Survey Fieldbook data dialog) right click on a station name and select **Route** from the pop up menu. The Build Single Route dialog will appear.  
Note: If your network is not displaying, open the Network Symbology dialog and make sure Traverse and Points are checked on for display.  
**Survey > Network Symbology**
3. From the Build Single Route dialog, select the **OK** button. If multiple Routes or a fork is part of the route, you can dynamically select them using the buttons at the top of the dialog.

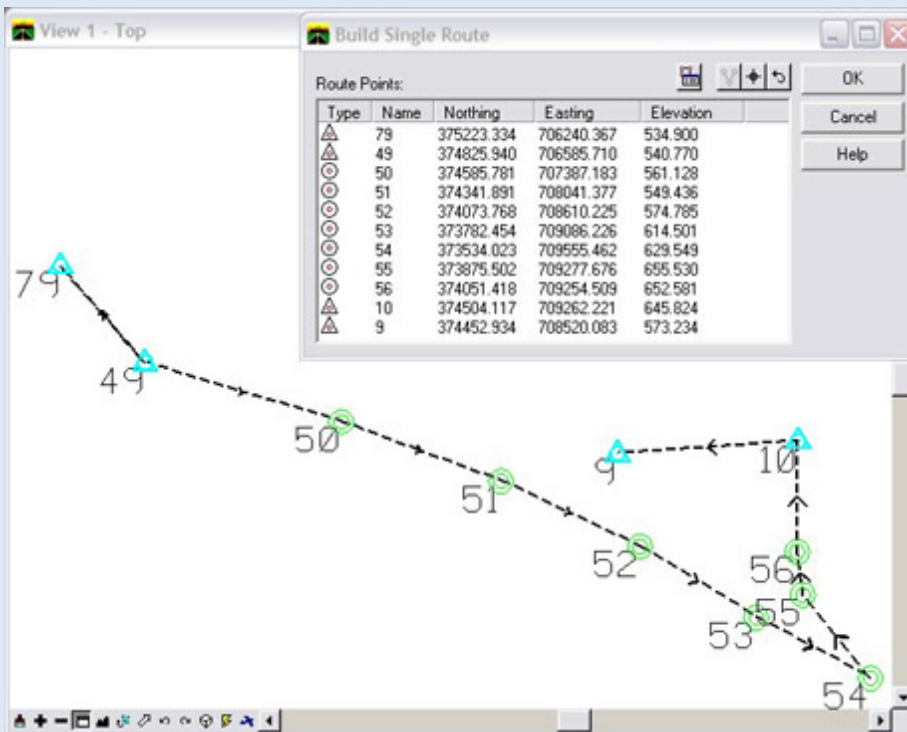

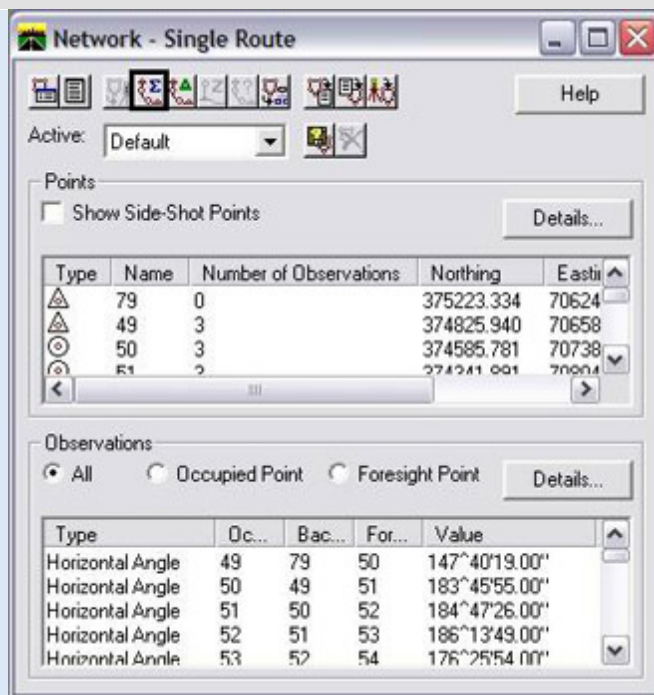

Points identified with a triangle are fixed points. Points identified with a circle are free points. InRoads Survey automatically recognizes the type of point from the way it is collected in the field.

4. From the Network – Single Route dialog you can select the Least Squares button.

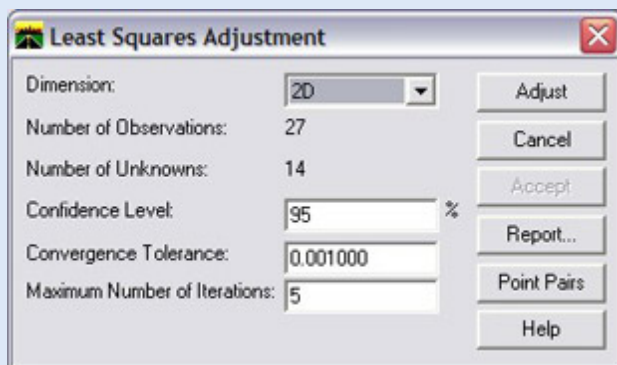

5. Select the **Adjust** then **Report** buttons. Review the XML report using one of the Survey Style sheets. If the adjustment is acceptable select the **Accept** button.



6. Push the adjustment back to the fieldbook using the Network to Fieldbook button  in the Network – Single Route dialog.

[ [Tip Archives](#) ]

## Open Enrollment Classes

<< back to top

### Open-Enrollment Classes With Seats Available.

<a href="#">MicroStation V8 - Fundamentals</a>	Jun. 4-7	Madison, WI
<a href="#">MicroStation V8 - User Upgrade</a>	Jul. 10-11	Madison, WI
<a href="#">MicroStation V8 - Power User</a>	Jul. 12-13	Madison, WI
<a href="#">MicroStation V8 - AccuDraw</a>	Aug. 17	Madison, WI
<a href="#">MicroStation V7 (J) - Fundamentals</a>	Aug. 21-24	Madison, WI
<a href="#">InRoads - Survey</a>	Jul 19-20	Madison, WI
<a href="#">InRoads - Fundamentals</a>	Aug. 6-10	Madison, WI

---

To be removed from this monthly newsletter, please reply to this message and note your wishes.

[Top](#) | [Contact us](#) | [Visit our web site](#)